

SELECTED PROJECTS

VLAD SIMIONESCU & ASOCIATII ARHITECTI

1995 - 2014

HEALTHCARE & HOSPITALITY

Sea Hawk Hotel and Resort Fukuoka, Japan, 1996, 1052 Room Convention Hotel (within Cesar Pelli Architects)

Crawford Long Hospital, Atlanta, GA USA, Emory Flealthcare (with Pickard Chilton Architects)

Guest House and Nursing Home Romanian Academy Of Science, 2008

OFFICE

Iasi Office and Commercial Building, Iasi 2014

Lakeview Office Building AIG Lincoln

National Romanian Public Television Headquarters TVR SA

Cotroceni Office Building Montero SA

Urdareanu Office Building Sebimob SA

Siret 95 Office Building Cyrom SA

Simar Office Building Simar SA

Wachovia Park Wachovia Bank

The Pinnacle Office Building Cousins Properties

24th & Camelback Office Building Hines Gray Partnership

Victory Tower Hicks Tate Muse & Furst

RESIDENTIAL

City Point Residential Aviatiei Nord Realestate Development

Private residence Corbeanca

Adora Pipera Residential Tagor

Edenia Residential, Bucuresti 2013

Romfelt Plaza Romfelt Real Estate SA

Parcul Tineretului Residential Towers Hanner RD

Parcul Copilului Apartments Building Cyrom SA

Varbila Vacation Houses Petromservice SA

Arcadia Complex Arcadia SA

Parcul Circului Apartments Building

Private residence 101 Bucuresti

Private residence 301 Paulesti

Private residence 303 Baneasa

Private residence SB402 Corbeanca

Private residence 509 Corbeanca

INDUSTRIAL

Industrial Complex Conversion Pumac SA

Office building and Warehouse Obo Betterman Romania

Pharmaceutical Distribution Center Montero SA

TNT Headquarters and Distribution Center TNT SA

RETAIL

Braila Retail Center Winmarkt

Piatra Neamt Retail Center Winmarkt

Omnia Ploiesti Retail Center Winmarkt

Cocor Department Store Cocor SA

Kaufland Romania Headquarters and Store Kaufland Romania SA

Luxury Department Store Grivco SA

SPECIAL PROJECTS

Petronas Towers and **Skybridge** (within Cesar Pelli Architects)

Romanian North Pole Research Center Romanian Academy Of Science

Athenansa Mihai Eminescu Memorial House Mihai Eminescu Research Center

NATIONAL ROMANIAN PUBLIC TELEVISION HEADQUARTERS



Location: Bucharest, Romania
Gross Area: 12.000 sqm
Client: National Romanian Public Television
Not built

VLAD SIMIONESCU & ASOCIATII
ARHITECTI

The new National Romanian Television Headquarters was designed as a sculptural building with a strong symbolic charge. The silhouette was inspired by Brancusi's Bird and the overall design was aimed at creating a representative 21-st century building for the National Romanian Public Television.

NATIONAL ROMANIAN PUBLIC TELEVISION HEADQUARTERS



MOLDOVA BUSINESS CENTER



Location: Iasi, Romania
Gross Area: 18,000 sqm
Year of completion: 2015
Client: Rivium Galeria Mall

VLAD SIMIONESCU & ASOCIATII
ARHITECTI

Moldova Business Center is located in the heart of Iasi, in close proximity to the town's heritage landmark buildings: The Culture Palace, The Dosoftei House and The Three Holy Hierarchs Monastery.

The project transforms the outdated Moldova Mall into a modern Class A Office Building. The new image is solid and elegant and it endeavors to create a striking presence within the city's fabric.

LAKEVIEW OFFICE BUILDING



LAKEVIEW OFFICE BUILDING



Location: Bucharest, Romania

Gross area: 47,000 sqm

Under Construction; Year of completion: 2009

Client: AIG / Lincoln

VLAD SIMIONESCU & ASOCIATII
ARHITECTI

The Building is located in the North Bucharest Area along Barbu Vacarescu Boulevard, close to the Floreasca Lake.

The silhouette of the building was imposed by zoning restrictions. The architecture, appropriate for a modern Class A Office building, is detailed with care for both day and night image of the building. A unique look and presence in the city will be ensured by the sophisticated lighting system, with color change LED fixtures lighting sandblasted glasspanes in a predetermined pattern.

The landscaping of the corner plaza creates a lush and sculptural garden for the enjoyment of the building users and its visitors.

CAMINA DEVELOPMENT



Location: Bucharest, Romania

Gross area: 100,000 sqm

Client: CCAI SA

Not built

VLAD SIMIONESCU & ASOCIATII
ARHITECTI

The Project is strategically located in the North Bucharest Area, at the heart of the new business and high-end residential developments, on the edge of Banease Lake.

The Development comprises: 20,000 sqm Class A New Office Buildings (2 building wings); 3,900 sqm Class A Office in 3 Historical Newly Restored Buildings (one main Building and 2 adjacent villas); a 9 stories Parking Garage with 504 car spaces; a 84 rooms, 6 stars Designer Hotel and a 6 stories Luxury Apartments Residential Building.

The Main Historical Building (ICA), the jewel of the complex, is carefully restored, with period interior details, a spectacular atrium with a decorative vaulted skylight. The building is housing office spaces, conference rooms, a private club and a fitness facility.

The 6 stars Hotel and the Luxury Apartments Building have contemporary, simple design, with balconies opening toward the lake, a private garden on the edge of the Baneasa Lake.

The Hotel will benefit from a Luxury Spa and fitness club, 2 restaurants, a designer cafeteria, one business lounge and one executive lounge area. The Luxury Apartment Building will have 24 hours administrative, maintenance and security service, as well as a dedicated catering service.

The whole area of the Project will be carefully landscaped, with public seating spaces, fountains, and a beautiful Lake promenade.

CAMINA DEVELOPMENT



COTROCENI



Location: Bucharest, Romania

Gross Area: 1000 sqm

Year of completion: 2004

Client: Montero SA

VLAD SIMIONESCU & ASOCIATII
ARHITECTI

The project undertook an abandoned concrete structure and developed it into a smart office building to be used floor by floor by small-medium sized firms. The building is located in the heart of the Cotroceni district, close to down-town and hosts our own office on the second floor.

The main façade uses ceramic, wood and glass to create a modern composition. The glass corner stacks vertically the Entrance lobby and conference rooms for each floor.

URDAREANU OFFICE BUILDING



Location: Bucharest, Romania

Gross area: 3,900 sqm

Year of completion: 2007

Client: Sebibmob SA

VLAD SIMIONESCU & ASOCIATII
ARHITECTI

The building is located in one of the fast developing areas of the city, formerly a heavy industry district, within 10 minutes walk to the Parliament Building.

The design was developed to accommodate a tight budget while creating a modern airy look for the building. The Penthouse hosts a café with a generous terrace, a favorite lunch spot for the building's users as well as for outside visitors.

WACHOWIA PARK



Location: Winston-Salem, USA

Gross Area: 23.000 sqm

Year of completion: 1998

Client: Wachovia Bank

Designed in collaboration with Pickard Chilton Architects

VLAD SIMIONESCU & ASOCIATII
ARHITECTI

When Wachovia Bank expanded nationally, the need for more office space for their Headquarters became stringent. The company acquired for this purpose a property strategically located across its old headquarters office tower, on the edge of the prestigious Coperning Park.

The Project, although smaller in scale as the Wachovia Tower, was addressed with the same care for detail both for functional usability and aesthetics.

The two entrance halls, one towards Cherry Street, a simple yet elegant two story space and the other one towards the Park, a six story atrium with Black olive trees and relaxing water features, guide the users to the elevator Lobby.

WACHOWIA PARK



THE PINNACLE



Location: Atlanta, USA
Gross Area: 79.000 sqm
Year of completion: 1998
Client: Cousins Properties
Designed in collaboration with Pickard Chilton Architects

VLAD SIMIONESCU & ASOCIATII
ARHITECTI

The Pinnacle is a high profile office hosting the regional headquarters for Merrill Lynch, Paine Webber and Morgan Stanley & A.T. Kerney. The building is located in the heart of the Buckhead Area in Atlanta, on the corner of Peachtree and Lenox Street. The roof of the building, modeled as a glass sail, make for a striking and memorable silhouette. On top of the 25th floor there is a Garden roof, sheltered from the wind by a 2.00 m high glass parapet.

The base of the building benefits from a just as powerful crescent shape, the location of a very trendy and elegant restaurant. The Entrance Lobby with its backlit glass walls and anigre-wood panels set the tunes for an elegant yet modern and progressive interior, in tune with the corporate image of its tenants.

THE PINNACLE



24TH & CAMELBACK OFFICE BUILDING

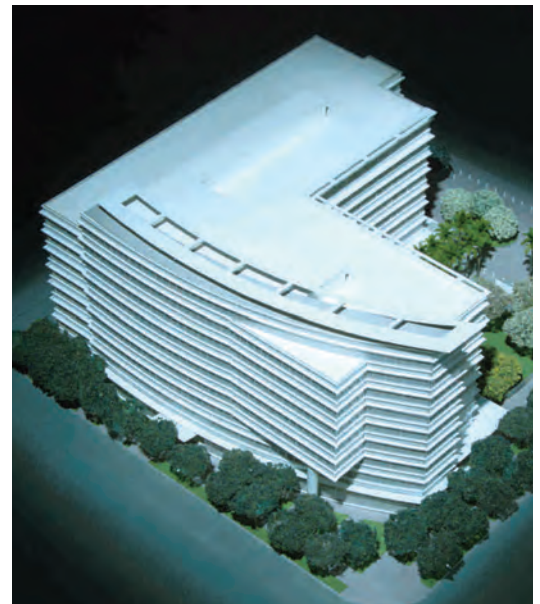

Location: Phoenix, Arizona, USA

Gross area: 51.100 sqm

Year of completion: 2000

Client: Hines Gray Partnership

Designed in collaboration with Pickard Chilton Architects

VLAD SIMIONESCU & ASOCIATII
ARHITECTI

24th & Camelback Office Building set a new standard for office and mixed-use buildings in downtown Phoenix. Part of a bigger urban development, the building was designed to allow for a vivid social life, both during the day, at lunch breaks, and after offices close down. The ground floor of the building is occupied by restaurants and cafes. The L-shaped building provides a garden plaza sheltered from the traffic and the strong sun of Phoenix.

The shape of the building was designed for maximum floor efficiency, but by the clever introduction of a curving wall on just a few floors a very dynamic effect is achieved.

VICTORY TOWER



Location: Dallas, USA

Gross Area: 111.500 sqm

Client: Hicks Muse Tate & Furst

Designed in collaboration with Pickard Chilton Architects

Not built

VLAD SIMIONESCU & ASOCIATII
ARHITECTI

Victory Tower was designed to be a symbol of the transformation of Dallas into a leading finance city and 21st Century technology. It was designed to revive the urban and community life through the incorporation of cafes, restaurants and shops that would compliment the American Airlines Sports Arena.

The complex geometry of the plans gets worked up into a beautiful and strong urban silhouette.

COCOR DEPARTMENT STORE



Location: Bucharest, Romania

Gross Area: 25,000 sqm

Under construction

Client: Cocor SA

VLAD SIMIONESCU & ASOCIATII
ARHITECTI

Cocor Department store is one of the oldest and best known department stores in downtown Bucharest. The Owner decided to upgrade both the interior and exterior of the existing building to reaffirm its position as a leading retail center.

The Design makes use of multimedia panels and facades and turns the currently closed box of the building into a lively one. The Project develops a Pedestrian Plaza to the side of the building towards Baratia Church and an urban retail portico towards the Boulevard.

The terrace at the top of the building café will become a favorite among tourists, given is panoramic view over the old City.

COCOR DEPARTMENT STORE



WINMARKT PLOIESTI



Location: Ploiesti, Romania
Gross Area: 18,000 sqm
Year of completion: 2015
Client: Win Magazin SA

VLAD SIMIONESCU & ASOCIATII
ARHITECTI

Winmarkt Ploiesti is located in the heart of Ploiesti, in close proximity to the town's heritage landmark buildings: The Culture Palace, The Dosoftei House and The Three Holy Hierarchs Monastery.

The project transforms the outdated Omnia Retail Center through the use of softly-colored ceramic panels and striking building sized advertising glass boxes.

WINMARKT PIATRA NEAMT



Location: Piatra Neamt, Romania
Gross Area: 16,000 sqm
Year of completion: 2013
Client: WinMagazin SA

VLAD SIMIONESCU & ASOCIATII
ARHITECTI

Winmarkt is located within the downtown of the picturesque city of Piatra Neamt, in the North-East Part of Romania. Piatra Neamt is the capital city of the Neamt County and has a population of 100,000 people.

The project transforms an outdated 1970's building, set close to the Bistrita River, into a modern, attractive retail center, activating the city's urban fabric with a vibrant presence.

The façade texture uses silver metal panels and building sized glass boxes, which are animated by dynamic color changing lights and seasonal advertising installations.

A bright red canopy calls the attention of people strolling through downtown and makes the building a strong retail anchor.

CRAWFORD LONG HOSPITAL



Location: Atlanta, Georgia

Gross area: 186.000 sqm

Year of completion: 2002

Client: Cousins + Emory Healthcare/ Crawford Long Hospital

Designed in collaboration with Pickard Chilton Architects

VLAD SIMIONESCU & ASOCIATII
ARHITECTI

Crawford Long Hospital, is part of the prestigious Emory Healthcare system, and is strategically located in the heart of Atlanta.

The Complex consists of a Medical Office Building (50,000 sqm), a Diagnostic and Treatment Center (50,000 sqm), a Cancer Clinic (2,000sqm) and a Parking serving all facilities.

The Project was design and developed with utmost care for the Patient, including state of the art medical technology within a friendly and optimistic environment.

The Main Entrance is made through a Conservatory filled with beautiful black-olive trees, seasonal and perennial local and tropical flowers.

CRAWFORD LONG HOSPITAL



GUEST HOUSE AND NURSING HOME - ROMANIAN ACADEMY OF SCIENCE



Location: Otopeni, Romania

Gross Area: 1392 sqm

Year of completion: 2005

Client: Romanian Academy of Science and Elias Foundation

VLAD SIMIONESCU & ASOCIATII
ARHITECTI

The project is located on the outskirts of Bucharest, in Otopeni, in a nice tree shaded area.

The design and volumetry took inspiration from the traditional architecture of old Romanian guest houses. The building, has a simple yet elegant shape, which together with the existing building and the surrounding trees creates a silent peaceful oasis for its residents, retired members of The Romanian Academy.

GUEST HOUSE AND NURSING HOME - ROMANIAN ACADEMY OF SCIENCE



ROMFELT PLAZA



Location: Bucharest, Romania

Gross Area: 90,000 sqm

Under Construction ; Year of completion: 2008

Client: Romfelt SA

VLAD SIMIONESCU & ASOCIATII
ARHITECTI

The project develops a total of 616 apartments stacked into a sculptural colourful complex of P+24, P+16 and P+4 buildings. The Complex is located in the East side of Bucharest, close to the strong commercial area developed in and around Piata Obor. The apartment's size varies from 45 sqm for studios to 140 sqm for 3-bedroom apartments.

ROMFELT PLAZA



DOMENII PARK



Location: Bucharest, Romania
Gross Area: 18,000 sqm
Year of completion: 2011
Client: Cyrom Investments

VLAD SIMIONESCU & ASOCIATII
ARHITECTI

The building is located on the South side of Parcul Copilului, a 4.00 ha public park, with big old trees, promenade alleys and children playground.

The main façade is oriented towards North and a series of East oriented alcoves are designed to bring the morning sun into the building.

DOMENII PARK



CITY POINT



Location: Bucuresti, Romania
Gross Area: 15,000 sqm
Year of completion: 2014
Client: Aviatiei Nord Development

VLAD SIMIONESCU & ASOCIATII
ARHITECTI

City Point is a new residential development in the heart of the new business district of Barbu-Vacarescu – Pipera in Bucharest, Romania.

The project offers a high quality, peaceful environment for the areas residents. On ground level there are carefully landscaped green common recreation areas. All apartments have spacious loggias and the ground floor apartments benefit from private gardens.

The buildings are crowned with distinctive canopies, which give the buildings a strong urban identity.

PARCUL TINERETULUI RESIDENTIAL TOWERS



Location: Bucharest, Romania

Gross Area: 3000 sqm

Under Construction ; Year of completion: 2008

Client: Romfelt SA

VLAD SIMIONESCU & ASOCIATII
ARHITECTI

The Four Towers (P+11, P+9) are located on the South Side of Parcul Tineretului, the second largest public park of Bucharest. The Project has 198 apartments in 4 buildings, each with spectacular views towards the park. The apartment's size varies from 50 sqm to a maximum of 125 sqm.

PRIVATE RESIDENCE 509 Corbeanca



Location: Corbeanca, Romania

Gross Area: 780 sqm

Not built

VLAD SIMIONESCU & ASOCIATII
ARHITECTI

Located amidst a beautiful forest, the building was designed as a discreet composition of low horizontal volumes. The warmth of the wood paneling speaks to the natural environment whereas the transparency of the glass unifies the interior spaces with the exterior.

PRIVATE RESIDENCE 301 Paulesti



Location: Paulesti, Romania

Gross Area: 2200 sqm

Year of completion: 2007

VLAD SIMIONESCU & ASOCIATII
ARHITECTI

The property is developed for a 3 generations family, with a Master wing and a Children and Grandchildren on. The master plan and general lay-out of the buildings generously allow for distinct entertaining and family zones, maintenance staff, gardening and farming.

The natural setting of 30,000 sqm comprises a 14m deep valley, wooded slopes and a lake.

The architecture is inspired by the Romanian traditional noble houses, with its decoration muted into a modern language. The main finishes are solid oak and meranti, marble and granite stone.

PRIVATE RESIDENCE 303 Dr. A



Location: Bucharest, Romania

Gross Area: 410 sqm

Year of completion: 2003

VLAD SIMIONESCU & ASOCIATII
ARHITECTI

The architecture of this residence was generated by its very unique natural setting, two beautiful cedar trees sitting in the center of the property. The house revolves around the trees. The composition is dynamic and allows for dramatic yet minimalist interior volumes. The choice of materials: natural stone, solid wood allow a seamless integration of the building with the natural environment.

VARBILA VACATION HOUSES



Location: Varbila, Romania

Gross Area: 1000 sqm

Year of completion: 2005

Client: Petromservice SA

VLAD SIMIONESCU & ASOCIATII
ARHITECTI

The complex is set onto a beautiful site, covered with maple and oak trees , opening up to Varbila lake. The three guest houses, done in wood, are located as such to each benefit from the lake view and to have private entertaining areas. A beautiful wood structure gazebo, floats on the water some 100m from the shore.

VARBILA VACATION HOUSES



PRIVATE RESIDENCE SB402 Corbeanca



Location: Corbeanca, Romania
Gross Area: 3000 sqm
Year of completion: 2008

VLAD SIMIONESCU & ASOCIATII
ARHITECTI

The house is located on the edge of Corbeanca lake, some 20 km off downtown Bucharest, in an area that is currently subject to intense residential development.

The building is structured in 3 pavilions and have a dramatic sail shaped roof. The project has the sculptural feel of an expressionist building. The architecture is powerful yet simple, the spaces are generous and light, airy and calm. The detailing is rich and sophisticated.

INDUSTRIAL SPACE CONVERSION – MULTIPLEX CINEMA



Location: Bucharest, Romania
Gross Area: 2640 sqm
Client: PUMAC SA
(not built)

VLAD SIMIONESCU & ASOCIATII
ARHITECTI

The project was designed to convert a large industrial building into a multifunctional center, with cinemas and supporting retail space. The proposal benefits from the great flexibility given by the large clear span and height of the building and proposes an interior promenade to anchor all retail and entertainment spaces.

The architecture is fresh, transparent and modern, responding to the targeted users: the students and staff of the adjacent Polytechnic University.

OBO BETTERMAN ROMANIA HEADQUARTERS



Location: Magurele, Romania

Gross Area: 4090 sqm

Year of completion: 2004

Client: Obo Betterman Romania SA

VLAD SIMIONESCU & ASOCIATII
ARHITECTI

The Office Building was designed to locate the Headquarters of Obo Betterman Romania. Adjacent to the office building sits the main warehouse and a showroom for the quality Obo Betterman electrical materials.

The shape is simple and clear, a reflection of the company's own policy and credo for its business, products and services.

OBO BETTERMANN ROMANIA HEADQUARTERS



MONTERO DISTRIBUTION CENTER



Location: Bucharest, Romania

Gross Area: 3000 sqm

Year of completion: 2003

Client: Montero SA

VLAD SIMIONESCU & ASOCIATII
ARHITECTI

The project undertook the renovation and conversion of two 1915 industrial buildings, formerly used by a bearing balls factory .

The exterior of the building was renovated as per the original image of the building. A couple of canopies and solid wood shutters were added for functionality.

The front section of the building, formerly dressing rooms for the workers, was converted for office use.

MONTERO DISTRIBUTION CENTER



OFFICE BUILDING AND WAREHOUSE FOR TNT - ROMANIA



Location: Otopeni, Romania

Gross Area: 3100 sqm

Year of completion: 2007

Client: CCAI SA + TNT Romania

VLAD SIMIONESCU & ASOCIATII
ARHITECTI

The Office Building was designed to locate the Headquarters of TNT Romania and its main warehouse and distribution center for incoming and outgoing parcels through the International Airport Henri Coanda

The color scheme was based on the corporate colors for TNT. The volumes and space lay-out had to respond to strict functional requirements to ensure fast and effective processing of post parcels.

OFFICE BUILDING AND WAREHOUSE FOR TNT - ROMANIA



KAUFLAND ROMANIA HEADQUARTERS AND STORE



Location: Bucharest, Romania

Gross Area: 14,200 sqm

Year of completion: 2007

Client: Kaufland Romania

VLAD SIMIONESCU & ASOCIATII
ARHITECTI

The Project located on one of the major N-S axis of Bucharest: Barbu Vacarescu Boulevard hosts the Headquarter Offices for Kaufland Romania and its most representative store. Kaufland is one of the largest and most representative supermarket operators in Romania.

The Entry to the store is done through a two-storey portico. The office building has separate access through a carefully designed double height wood paneled lobby.

PETRONAS TOWERS

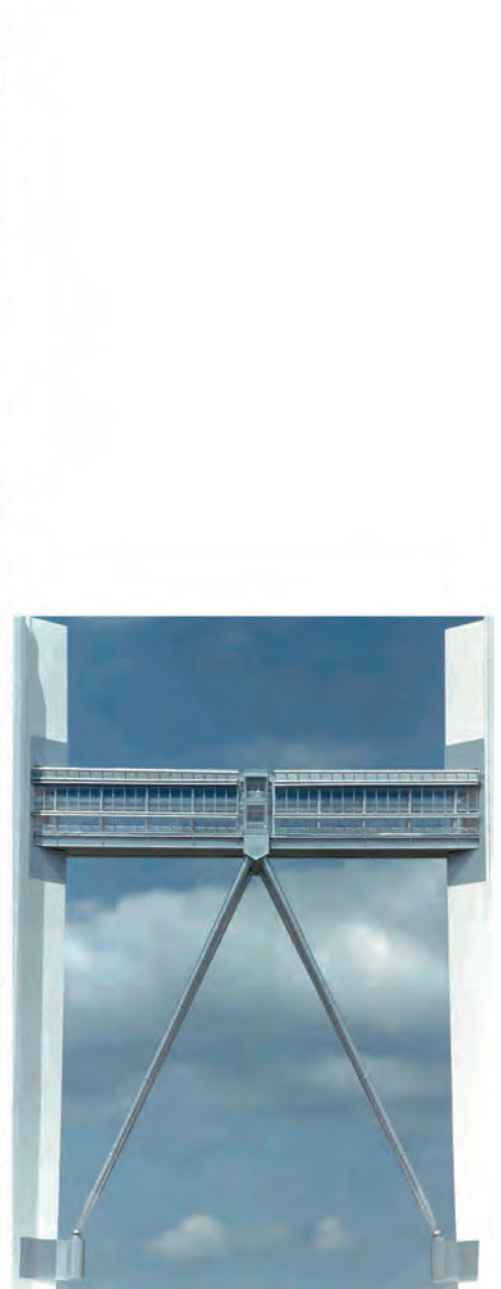

Location: Kuala Lumpur, Malaysia

Gross area: 650.300 sqm

Year of completion: 1996

Client: Kuala Lumpur City Center

Designed within Cesar Pelli & Associates Architects

VLAD SIMIONESCU & ASOCIATII

ARHITECTI

Kuala Lumpur City Centre is a complex of buildings covering a site of almost 40 acres in downtown Kuala Lumpur.

The Petronas Towers, till recently the highest buildings in the world at 452 m height, became an iconic symbol for Malaysia. The Skybridge connecting the two towers up on the 41st and 42nd floor creates a monumental gate for the City. At street level the Towers are connected by a Retail Gallery, a Museum and a Concert Hall.

At the center of the Retail Gallery is a beautiful 6 stories Atrium covered by a delicate, lacey looking structure of an oval skylight 38 x 48 m.

The shape of the Towers was generated starting from a traditional Muslim geometrical motif: that of two rotated and superimposed squares.

PETRONAS TOWERS



KUALA LUMPUR CITY CENTER



KUALA LUMPUR CITY CENTER



KUALA LUMPUR CITY CENTER



ROMANIAN NORTH POLE RESEARCH STATION



STATIA POLARA NATIONALA - ROMANIA / propunerea nr.2

scara 1:150



GHETARI



AQUAMARINE

LOCATIE: LONGYEARBYEN, SVALBARD, NORVEGIA.
longitudine 16° 03'E, latitudine 78° 09'N, altitudine 438m







FUNCTIE: STATIE POLARA NATIONALA - ROMANIA
explorare, adăpost, studiu







TEHNOLOGIE: SISTEM CONSTRUCTIV MODULAR DEMONTABIL
SISTEME CONSERVARE / ECONOMIE ENERGIE
PROIECTARE SOLARA PASIVA
ELEMENTE GLISANTE / FLEXIBILITATE SPATIU
MATERIALE DE CONSTRUCTIE NEPOLLUANTE
CONEXIUNE SATELIT / RADIO / INTERNET

CRISTAL CONSTRUIT contrast cu textura sitului

FLEXIBILITATEA SPATIULUI / PERETI GLISANTI

ora 7.00 : cafea, conversatie, instructaj

ora 18.00 : studiu, relaxare, conversatie, cina

Location: Longyearbyen, Svalbard

Gross Area: 300 sqm

Client: Romanian Academy of Science
(not built)

VLAD SIMIONESCU & ASOCIATII
ARHITECTI

The Romanian Academy of Science sponsored several expeditions and scientific research to be conducted in the North Pole area. Given Romania is one of the few countries to have received construction rights in Svalbard after WWII the Academy started to raise funds for a national polar station.

The proposals were part of a study to raise awareness and funds for scientific research in the North pole region. The projects were done pro-bono and developed 4 different concepts for the polar station which will host for a minimum of 3 months / year Romanian scientist teams. The main challenge of the design was to take into account the permafrost earth condition and the necessity for a prefabricated system to be built off site in Romania and assembled locally in Svalbard.

ROMANIAN NORTH POLE RESEARCH STATION

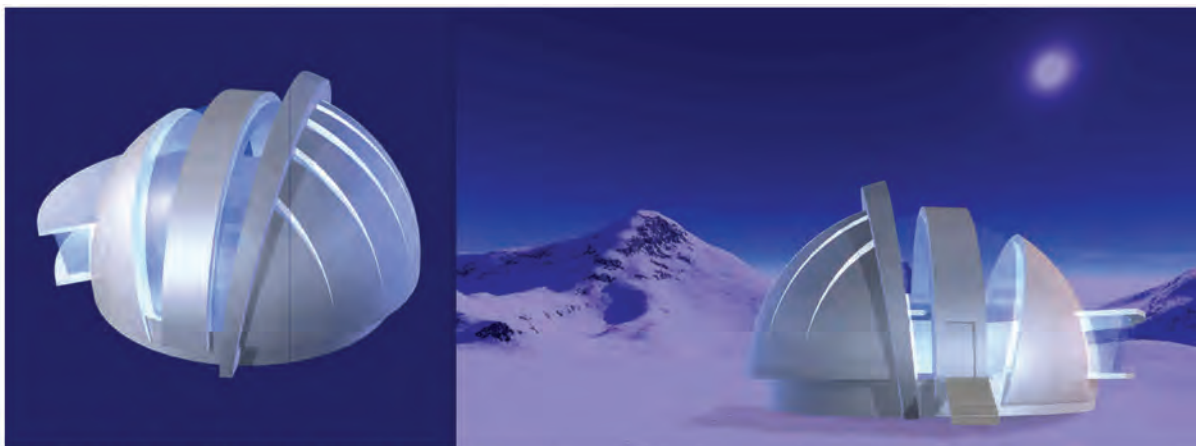

STATIE POLARA NATIONALA - ROMANIA / propunerea nr. 1

Ghetar. Apa cristalizata pastrand in adancurile ei trecutul.

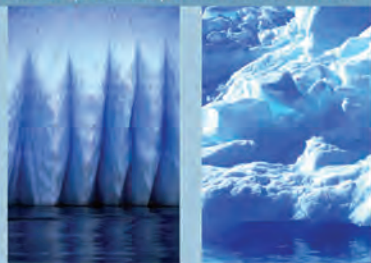

Igloo. Gheata imblanzita de om. Acoperis. Protectie. Scoala.



Straturi. Descompuneri succesive ale aceleiasi materii. Zgarieturi. Amprente formale. Miscari tectonice. Particule purtate de vanturile solare.



Fosila. Amprenta a trecutului ascunsa intre straturile de gheata. Dezvelire. **Descoperire.**



Simbol

In mijlocul naturii salbatice din Svalbard, omul se reprezinta prin propria esenta. Inteligenta. Spiritul. Lumea umana si activitatea ei.

Stiinta.

Silueta imbina referinte vizuale aparent separate exprimand complexitatea gandirii umane in eterna cautare a unei esente comune pentru toate lucrurile. Lumea este desfacuta si recompusa.

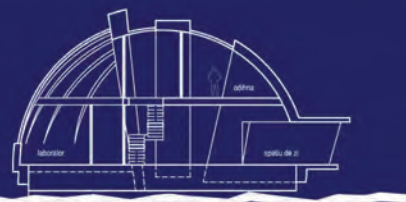

SECTIUNE NORD-SUD

Forma

Arhetipul inradacinat al adapostului uman (d)in zapada- igloo-ul. Taieturile oblice transforma volumul static intr-o perpetua descoperire dinamica ascunzand/dezvelind intimitatea.

In universul in care noaptea, ziua si vanturile solare se ingemaneaza la limita "realului", lumina este tratata ca un strat aparte - totala si copleesitoare sau discreta si filtrata.

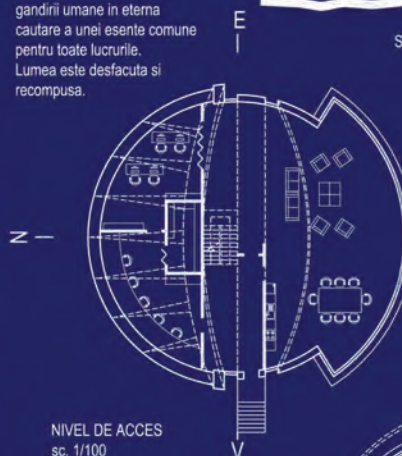

NIVEL DE ACCES
sc. 1/100

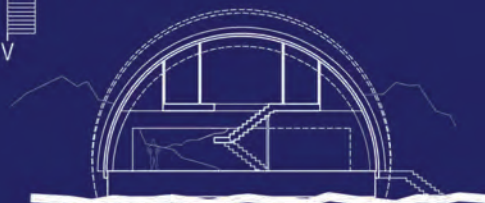

SECTIUNE EST-VEST

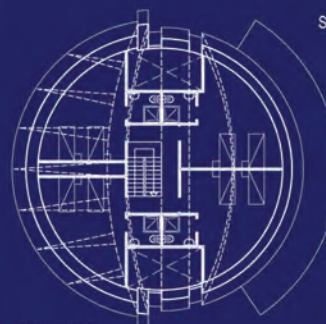

NIVEL SUPERIOR
sc. 1/100

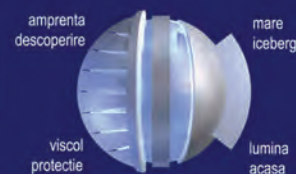

Vlad Simionescu & Asociatii Arhitecti

